



Swan Street **, West Malling ME19 6LW**

- GUIDE PRICE: £350,000-£375,000
- Situated in the Centre of the Village.
- Front and Rear Gardens
- A Two Bedroom House.
- A Brick Built Garage to Rear
- Vacant Possession Available

Guide Price £350,000 Freehold



Local Authority
Council Tax Band D
EPC Rating C



GROUND FLOOR

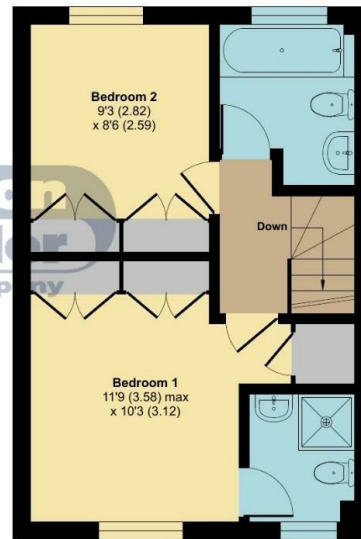

FIRST FLOOR

Swan Street, West Malling, ME19

Approximate Area = 730 sq ft / 67.8 sq m

For identification only - Not to scale

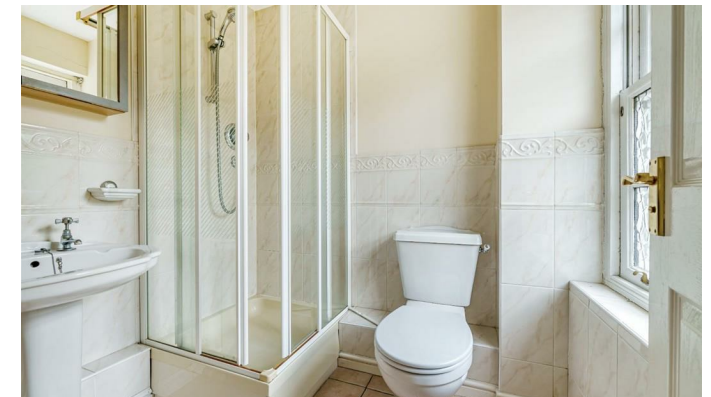

Floor plan produced in accordance with RICS Property Measurement Standards incorporating International Property Measurement Standards (IPMS2 Residential). © nichecom 2023. Produced for Simon Miller & Company. REF: 1037611

Malling Office

777 London Road, Larkfield, Aylesford,
Kent, ME20 6DE

Contact

01732 875706
larkfieldsales@simonmiller.co.uk
<https://simonmiller.co.uk/>

Agents Note: Whilst every care has been taken to prepare these particulars, they are for guidance purposes only. All measurements are approximate and for general guidance purposes only and whilst every care has been taken to ensure accuracy, they should not be relied upon and potential buyers/tenants are advised to recheck the measurements.